

ECS distribution valve

Function:
Control flow for ECS

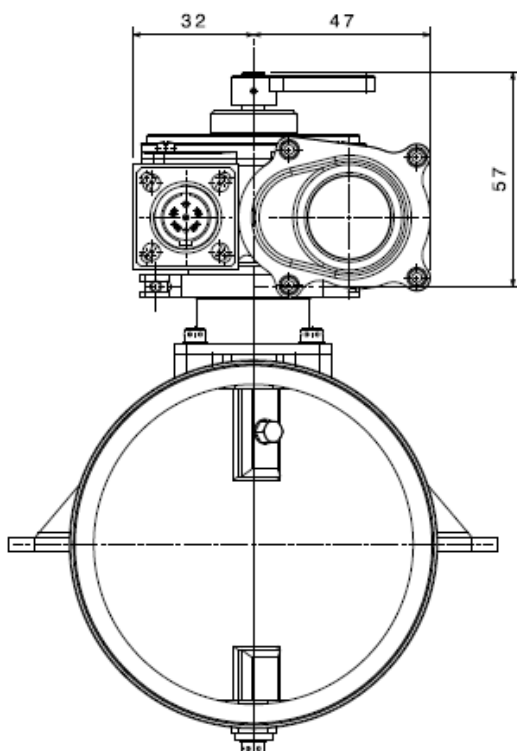
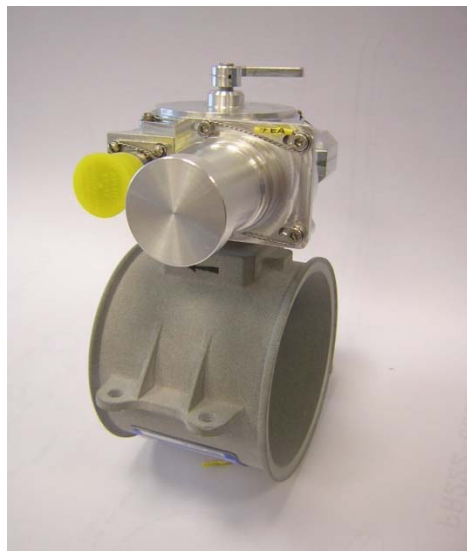

1. Status

Development in progress

2. Main performance

Max air inlet temperature 120°C (248°F)

Pressure drop < 0.008 bar (0.1psi)
(Valve full open) air flow 20kg/min
(air inlet temperature) 70°C (158°F)

Max air flow 20 kg/min

Max current to operate 0.4 A

Operating temperature -55 to 100°C
(ambient temperature) -67 to 212°F

Weight 0.950 kg (2 lb)

Internal leakage < 66 l/mn @ 70 mbar at 70°C

External leakage 15 l/min @70mbar at 70°C

Closing time < 8s

Opening time < 8s

Adaptations :

- Manual override
- Alternative detection position solution:
 - Switches
 - Optical sensors
 - Potentiometer
- Operating time

3. Reliability / maintainability

Reliability MTBF 25 000 FH

Maintainability On condition (LRU)

INNOVATIVE TECHNICAL SOLUTIONS
HIGH QUALITY
COMPETITIVE PRICES
EXPERIENCED WORKFORCE

Pôle de Buconis
32600 L'Isle Jourdain
FRANCE

Phone 33 (0) 562 07 07 17
Fax 33 (0) 562 07 07 28

E-mail equipaero@equipaero.com

Website www.equipaero.com



EQUIP'AERO
TECHNIQUE

Certified
EN9100
Part 21G
ISO 14001

ECS distribution valve

INNOVATIVE TECHNICAL SOLUTIONS
HIGH QUALITY
COMPETITIVE PRICES
EXPERIENCED WORKFORCE

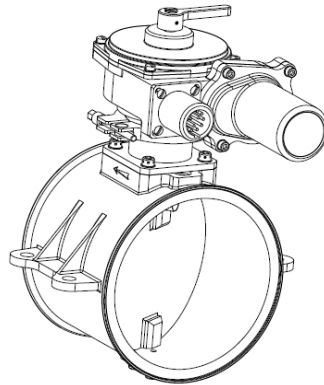
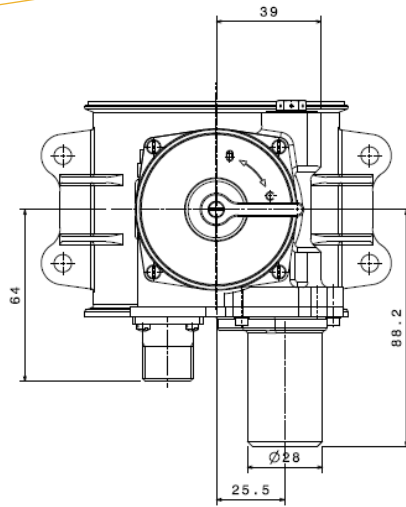

4. Mechanical interfaces

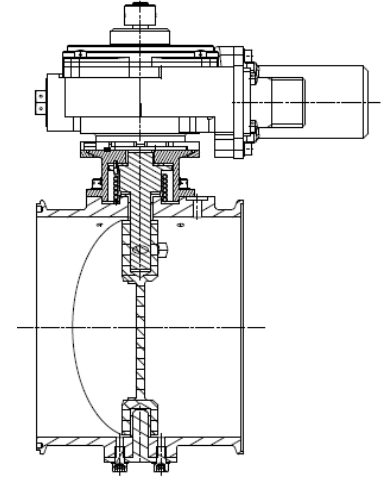

Inlet / outlet flange from Ø 2 to 5 in

5. Electrical interfaces

Connector type Adaptable by request

Electrical supply 18 to 30VDC

6. Qualification environment

Environment	Norm/Cat	Environment	Norm/Cat
High temperature	DO160 E §4	Explosion proofness	DO160 E §9
Low temperature	DO160 E §4	Proof pressure	Following CS-E and CS-25
Vibration	DO160 E §8.7 cat S curve C	Burst pressure	Following CS-E and CS-25
Operational shocks	DO160 E §7	Fire	DO160 E § 26
Crash safety	DO160 E §7	Endurance	18 000 cycles
Sand and dust	DO160 E §12	Voltage spike	DO160 E §17
Fluid susceptibility	DO160 E §11	Humidity	DO160 E § 6
Salt spray	DO160 E §14	Waterproofness	DO160 E § 10
Induction Icing	DO160 E §24	Power input	DO160 E § 16
Fungus resistance	DO160 E §13	Magnetic effect	DO160 E §15
Temperature/altitude	DO160 E § 4	EMI test	DO160 E §18 to 23
Thermal cycle	DO160 E §5 cat C	Electrostatic discharge	DO160 E §25

7. Equipment adaptations

Architecture and technologies adaptable on customer request

Body less valve,
3 ports distribution valve

Pôle de Buconis
32600 L'Isle Jourdain
FRANCE

Phone 33 (0) 562 07 07 17
Fax 33 (0) 562 07 07 28

E-mail equipaero@equipaero.com

Website www.equipaero.com



Certified
EN9100
Part 21G
ISO 14001